

Typical Application A.C. overhead systems up to 69 kV

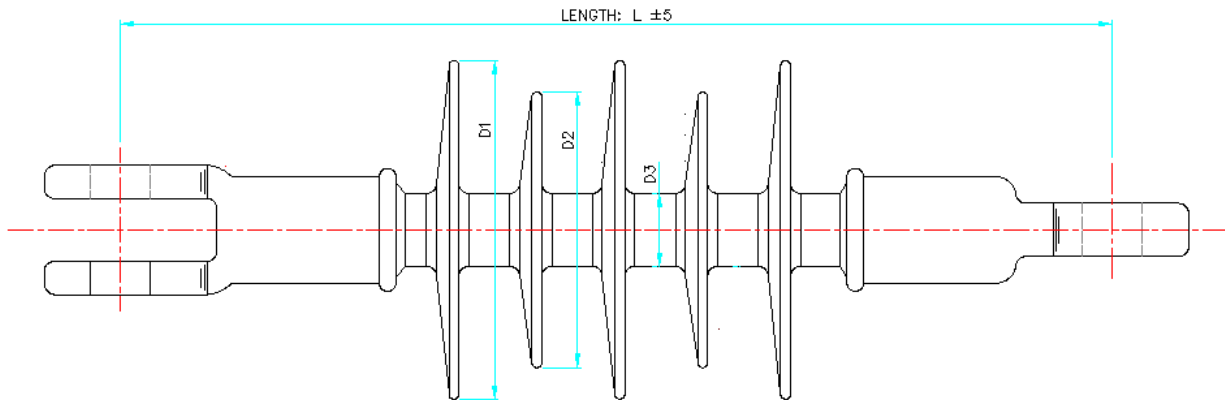

Dimensions in mm and given in inches in brackets ()

	RST-DS15 R-CT	RST-DS28 R-CT	RST-DS36 R-CT	RST-DS46 R-CT	RST-DS69 R-CT
Length L	318(12.5)	425(16.7)	474 (18.7)	613(24.1)	759(29.9)
Dry arc	170(6.7)	290 (11.42)	348(13.7)	450(17.7)	610(24.01)
Creepage	460(18.1)	690(27.1)	880(34.6)	1210(47.6)	1610(63.4)
No. of Sheds	5	7	9	13	18
Diameter D1	102(4.01)	97(3.8)	112 (4.4)	112(4.4)	112(4.4)
Diameter D2	83 (3.27)	78(3.07)	92(3.6)	92(3.6)	92(3.6)
Diameter D3	22 (0.87)	22(0.87)	28(1.1)	28(1.1)	28(1.1)

Electrical

Wet AC withstand (kV)	45	98	70	95	140
Impulse withstand (kV)	135	226	170	250	325

Mechanical in kN and given in lbs in brackets ()

Specified Mechanical Load SML	75(16860)	75(16860)	75(16860)	75(16860)	75(16860)
Routine test load RTL	37.5 (8430)	37.5 (8430)	37.5 (8430)	37.5(8430)	37.5(8430)

End fittings:

- Top :Clevis end fitting.
- Bottom :Tongue end fitting.
- Material :Galvanized Steel

The clevis fittings include a 16mm pin. The ball & socket end fittings are as per IEC120-16A. Other end fitting types are available on request.

The descriptions given above describe insulators with clevis and tongue end fittings. Tongue and clevis end fittings can be supplied in any orientation. These products are also available with ball & socket end fittings e.g. RST-DS15R-BS is a 15kV insulator with ball and socket end fittings.

Product range up to and including 69 kV, pollution class II and III according to IEC815.