

Typical Application

The SCTM/SCTM-N tubing provides the stress control function for cable terminations of solid plastic, rubber cables or PILC (MI/MIND). It replaces conventional tape or moulded stress cones. The tubing is normally used as an integral part of Raychem Cable Terminations above 1 kV. SCTM-N is considered for nuclear applications.

Colour = Black

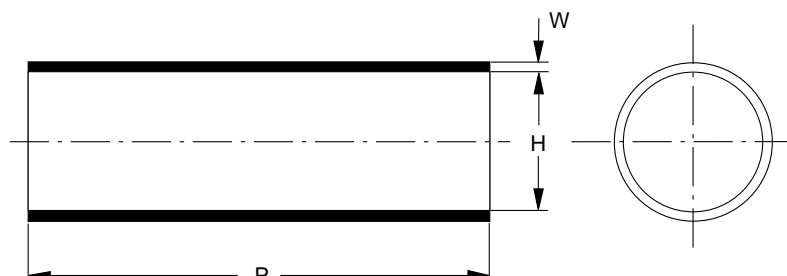

Standard Products Product Size	Application range diameter		Dimensions H		W b min	P	
	from mm	to mm	a min	b max		-4 spool m	-c spool m
	SCTM 20/7	9.6	17.6	20		7	1.4
SCTM 26/12	13.8	22.8	26	12	2	15	200
SCTM 32/14	16.1	27.2	32	14	2.2	-	200
SCTM 38/16	18.4	30.4	38	16	2.4	20	150
SCTM 46/19	21.9	36.1	46	19	2.4	15	150
SCTM 60/24	27.6	54	60	24	2.4	15	100
SCTM 76/33	38	62.7	76	33	2.8	10	100
SCTM 91/42	48.3	79.8	91	42	3	10	100
SCTM 106/53	61	100.7	106	53	2.8	-	100

Notes

- Dimensions in mm. a = as supplied, b = after free recovery
- Max. longitudinal change after free recovery:
± 5% for -05; + 5% to -10% for -50; +2% to -8% for 35;
spools and cut length
- Eccentricity : expanded 40% max.
fully recovered ≤ 46 /19 10% max,
≥ 60/24 15% max.
- Cut Length Tolerances: up to 100 mm ± 3 mm
> 100 mm ± 5 mm
> 300 mm ± 10 mm
≥ 1000 - 0 to + 40 mm
- Material meets requirements of PPS 3010/02 for SCTM. For SCTM-N material meets requirements of PPS 3010/49.

Printing Raychem - SCTM - Size - batch number - STRESS CONTROL
Packaging Small spools: min. continuous length 5m; max. 2 pcs + 1 Installation Instruction.